

# TOWNSHIP 5 S., RANGES 10 & 11 W.W.M. TILLAMOOK COUNTY ORE.

- STATE HWY (6) U.S. HWY (101) TRAILS
- PAVED HIGHWAYS
- IMPROVED DIRT ROADS
- DIRT ROADS
- INFERIOR ROADS
- RAILROADS
- INTERMITTENT CREEKS
- NAT'L FOREST BORYS. XXX
- ELEC. PWR. TRANS. LINES

**PLAT LIST**

- RANGE 11 WEST
- SEC. 24
- A. NEFF ADDITION
- B. OCEAN CREEK
- C. OCEAN CREEK, 1ST. ADD.
- SEC. 25
- A. BROWN ADD.
- B. THE POINT AT NESKOWIN
- SEC. 35
- A. NESKOWIN HEIGHTS
- B. NESKOWIN HEIGHTS, 1ST. ADD.

DATED FEB. 1974

To Cloverdale (40)

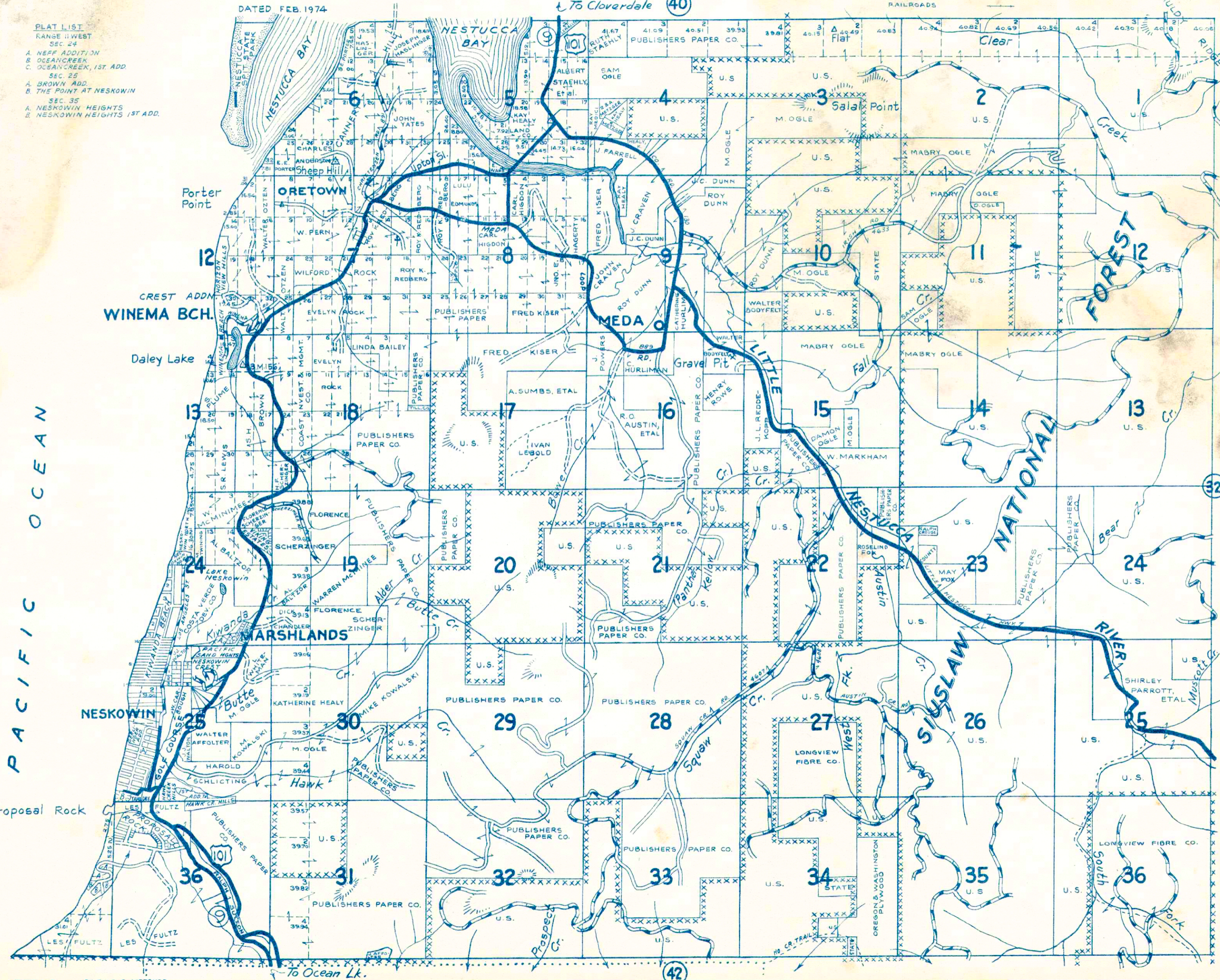

PACIFIC OCEAN

NATIONAL FOREST

Proposal Rock